

## STAINLESS STEEL MACHINE FEET

### TYPE M – FIXING

This model has an embedded fixing plate enabling the fixed foot to absorb vibration. Supplied with one or two fixing holes.

The vulcanized rubber conforms with FDA standard guidelines for rubber products concerning the food-industry. Smoothly rounded design for ease of cleaning.

Admits up to 5° slopes on floors and equipment.



#### Ordering example:

M76 - 5/8" - 4"

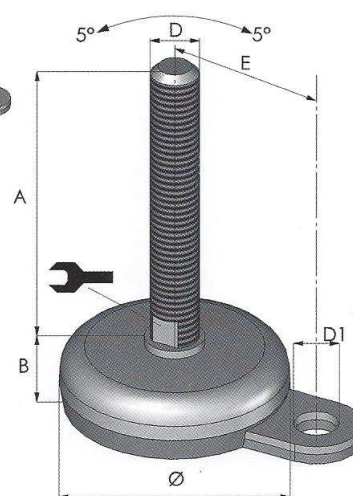
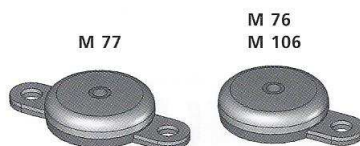

#### Foot plate

	M 76	M 77	M 106
Diameter Ø	2.95"	2.95"	3.94"
Height B	0.87"	0.87"	1.26"
Length E	2.05"	2.05"	2.64"
Hole diameter D1	5/8"	5/8"	5/8"
Nom. load	12.000 N	12.000 N	14.000 N

Foot plate and thread can be combined freely.

#### Thread

Length A*	D 3/8"UNC**	D 1/2"UNC	D 5/8"UNC	D 3/4"UNC	D 7/8"UNC	D 1"UNC	D 1 1/4"UNC
3"	3,51	3,93	4,95	6,64	8,21	11,50	-
4"	3,93	4,45	5,90	8,16	10,39	14,65	20,44
6"	4,23	5,07	7,03	10,06	13,42	18,70	25,06
8"	5,45	5,43	7,98	11,52	15,26	22,10	29,98
10"	6,10	6,10	9,11	13,41	17,34	26,58	37,40
12"	-	-	11,07	16,00	20,95	31,18	45,89
	5/16"	3/8"	1/2"	9/16"	5/8"	3/4"	1"